

- NOTES:
1. MATERIALS AND FINISHES:
BODY - BRASS, GOLD PLATING
CONTACT - BRASS, GOLD PLATING
INSULATOR - PTFE, NATURAL
2. ELECTRICAL;
A. IMPEDANCE: 50 OHM
B. FREQUENCY RANGE: DC - 12.4 GHz
C. VSWR (RETURN LOSS): 1.1 MAX @ DC - 6 GHz
1.2 MAX @ 6 - 12.4 GHz
D. DIELECTRIC WITHSTANDING VOLTAGE: 1000 VRMS, MIN.
3. MECHANICAL:
A. DURABILITY: 500 CYCLES MIN.
B. TEMPERATURE RANGE: -65°C TO +165°C
4. CABLE ASSEMBLY INSTRUCTIONS:
A. TRIM CABLE AS SHOWN.
B. SLIDE FERRULE AND INSULATOR DISC ONTO CABLE.
C. SOLDER CABLE CENTER CONDUCTOR TO CONTACT.
D. INSERT CABLE WITH FOIL ENTERING CONNECTOR AND BRAID OVER KNURL.
E. CRIMP FERRULE OVER BRAID WITH 0.255" HEX DIE.

5. SHOWS CABLE ENTRY DIMENSIONS.

THIRD ANGLE PROJ.

REVISIONS

REV	DESCRIPTION	DATE	ECN	APPR
A	RELEASE TO MFG.	11-Jun-15	2888	MD
B	OPTIMIZED FOR BETTER ELECTRICAL PERFORMANCE, UPDATED DRAWING FORMAT	08-Apr-19	--	SV

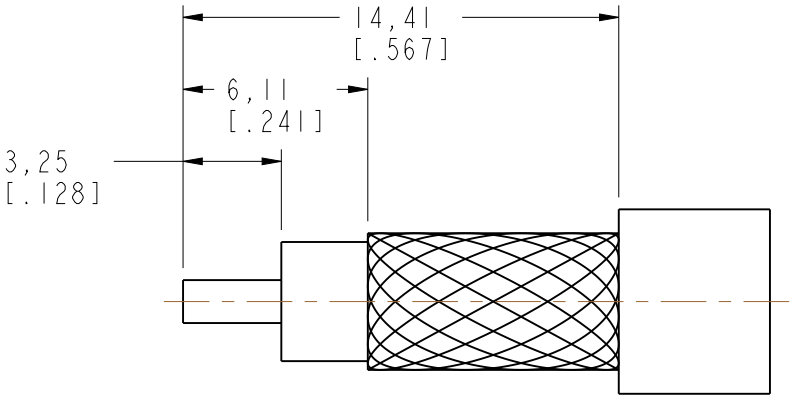

RECOMMENDED
CABLE STRIPPING DIM'S

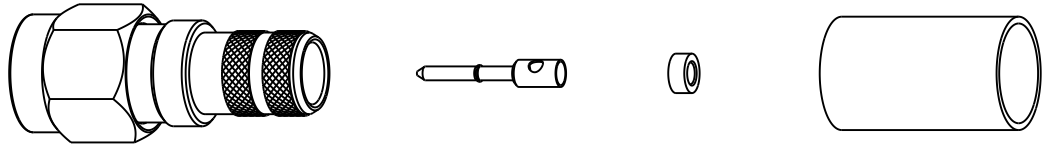

SCALE 2.000

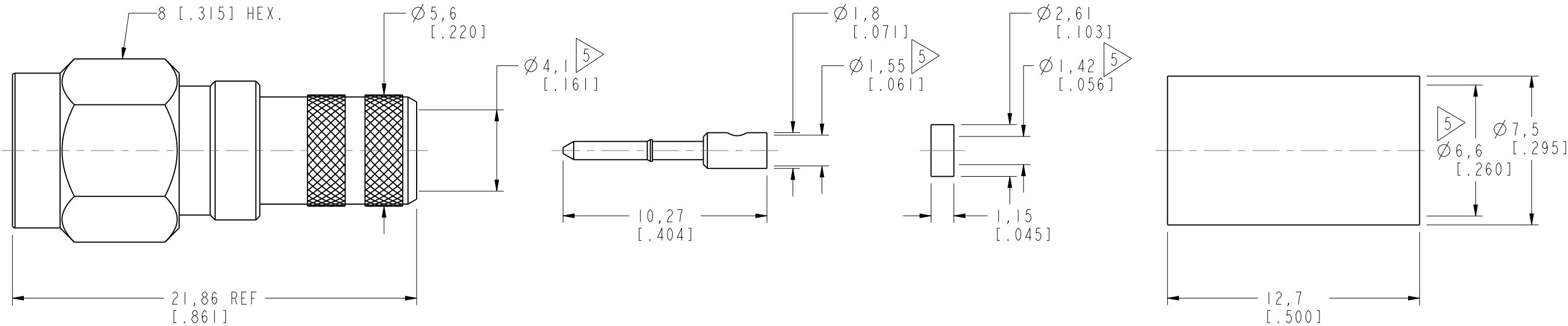

CUSTOMER OUTLINE DRAWING

ALL OTHER SHEETS ARE FOR INTERNAL USE ONLY

UNLESS OTHERWISE SPECIFIED, DIMENSIONS ARE IN METRIC AND TOLERANCES ARE: <0.5mm ± 0.05mm 0.5 - 6mm ± 0.1mm 6 - 30mm ± 0.2mm 30 - 120mm ± 0.3mm ANGLES ±1°	MATERIAL	DRAWN M. DONG	DATE 10-Dec-14	TITLE SMA CRIMP PLUG FOR LMR-240 CABLE		Amphenol RF www.amphenolrf.com	
	REFERENCE EAR# 6467 REF: --	ENGINEER S. DUAN	DATE 10-Dec-14				
	CONFIGURATION LEVEL: In Work	APPROVED S. HSIEH	DATE 15-Jun-15	SCALE: 4.5:1.0 SHEET 2 OF 2		DRAWING NO. SMA1111A6-004-3GT5GP-50	
	FINISH	CAD FILE		DWG SIZE B	REV B	ITEM NO. 111111ACP99FR5F	
						PART NO. 132451	