

1.0 PERFORMANCE

- 1.1 FREQUENCY RANGE: 2-6GHZ
 1.2 TEMPERATURE RANGE:-65° C TO +165° C
 1.3 IMPEDANCE: 50 OHMS
 1.4 INSULATION RESISTANCE: 5000M OHMS

2.0 MATERIALS

- 2.1 DIELECTRIC: PTFE
 2.2 CENTER CONTACT: BERYLLIUM BRONZE
 2.3 BODY:BRASS
 3.0 FINISHES
 3.1 CENTER CONTACT: GOLD PLATED
 3.2 BODY :GOLD PLATED
 4.0 THE CONNECTOR IS ROHS COMPLIANT.

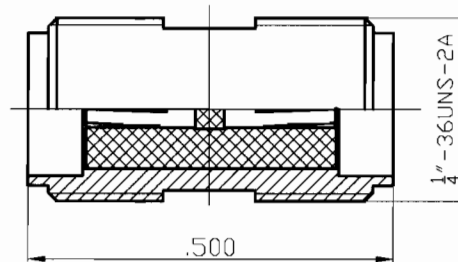

THIS DRAWING CONTAINS CONFIDENTIAL INFORMATION
 PROPRIETARY TO SDT INC. IT MUST NOT BE REPRODUCED OR
 DISCLOSED TO OTHERS OR USED IN ANY OTHER WAY, IN WHOLE
 OR PART EXCEPT AS AUTHORIZED IN WRITING BY SDT
 INCORPORATED.

UNLESS OTHERWISE SPECIFIED:
 ALL DIMENSIONS ARE IN INCHES.
 ALL DIMENSIONS ARE AFTER PLATING.
 .XXX= ± .005 ALL MACHINED SURFACES $\frac{1}{4}$ MAX.
 .XX= ± .010 ANG. ± 1/2° FRACTIONAL= ± 1/64

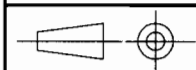

THIRD ANGLE PROJECTION

DWN	ZWG	08/20/08
CHKD	David	3/20-16
APPR		

Shanghai SDT Inc.

No.4 Lane 1175 Tongpu Rd., Shanghai, China, 200333

Fax: 021-52701318; Tel: 52701316; Email: sdpshe@sh163.net

TITLE

SMA/F-SMA/F ADAPTER

MATERIAL:

FINISH:

DO NOT SCALE
 DRAWING

DWG NO.

220-220-0

REV.
 0