

ATTENUATORS TYPE N

UP TO 18 GHz
25 WATTS

api 
technologies corp.
> INMET

MODELS: XXN25WR-XX, XXN25WR-XXF & XXN25WR-XXM

SPECIFICATIONS:

Electrical:

Frequency Range _____ DC - 18.0 GHz
Standard Freq. Values _____ 2.5, 6, 12.4 & 18 GHz
Standard dB Values _____ 0, 3, 6, 10, 20, 30 & 40 dB
Attenuation Accuracy DC - 6 GHz 6 - 12.4 GHz 12.4 - 18 GHz
3 - 6 dB _____ ±0.30 dB _____ ±0.50 dB _____ ±0.75 dB
7 - 20 dB _____ ±0.50 dB _____ ±0.75 dB _____ ±1.00 dB
21 - 30 dB _____ ±0.75 dB _____ ±1.00 dB _____ ±1.25 dB
31 - 40 dB _____ ±1.00 dB _____ ±1.25 dB _____ ±1.50 dB

VSWR

DC - 6 GHz _____ 1.20:1 Max.
6 - 12.4 GHz _____ 1.30:1 Max.
12.4 - 18 GHz _____ 1.40:1 Max.

Input Power _____ 25 Watts Avg. @ 25°C
DERATED LINEARLY TO 5 WATTS @ +125°C

Peak Power _____ 500 Watts Max.
(5uSec Pulse, .05% Duty Cycle)

Impedance _____ 50 Ohms

Operating Temp Range _____ -65°C to +125°C

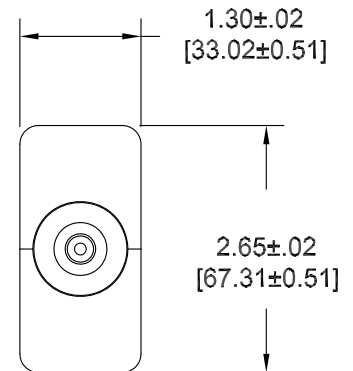

END VIEW
TYPICAL

Mechanical:

Type N Connectors _____ Passivated Stainless Steel
Mates with MIL-STD-348
Conductors _____ Gold Plated Beryllium Copper
Housing _____ Anodized Aluminum

Units must be Mounted in
such a way as to Allow for
Free Air Flow Around fins
as to Assure Performance.

Model Number: **XXN25WR-XX**

Male/Female Connectors
Length: 4.50 ±.05 [114.3 ±1.3]
Pictured

Model Number: **XXN25WR-XXF**

Female/Female Connectors
Length: 4.58 ±.05 [116.3 ±1.3]

Model Number: **XXN25WR-XXM**

Male/Male Connectors
Length: 4.41 ±.05 [112.0 ±1.3]

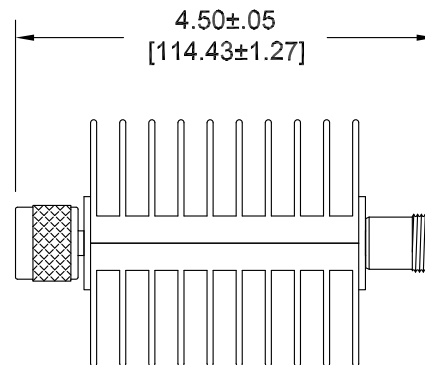

HOW TO ORDER:

Model Number: **XXN25WR-XXY**

Freq. Range _____

2 = DC - 2.5 GHz
6 = DC - 6 GHz
12 = DC - 12.4 GHz
18 = DC - 18 GHz

_____ dB Value

_____ Connector Config.

= Male/Female
F = Fem/Fem
M = Male/Male

Ordering Examples:

Model Number: **18N25WR-20**

DC - 18 GHz; 20 dB; Male/Fem

Model Number: **6N25WR-03F**

DC - 6 GHz; 3 dB; Fem/Fem

Note: Dimensions in Brackets are Expressed in Millimeters and are for Reference Only.

Design specifications are subject to change without notice.

Contact factory for technical specifications before purchasing or use.

XXN25WR-ATT; REV A

300 Dino Drive • Ann Arbor, MI 48103-9457 U.S.A. • 888-244-6638 or 734-426-5553 • FAX 734-426-5557 • inmet.apitech.com