

PAGE 1/2

ISSUE 1416B

SERIES QLI

PART NUMBER R184282007

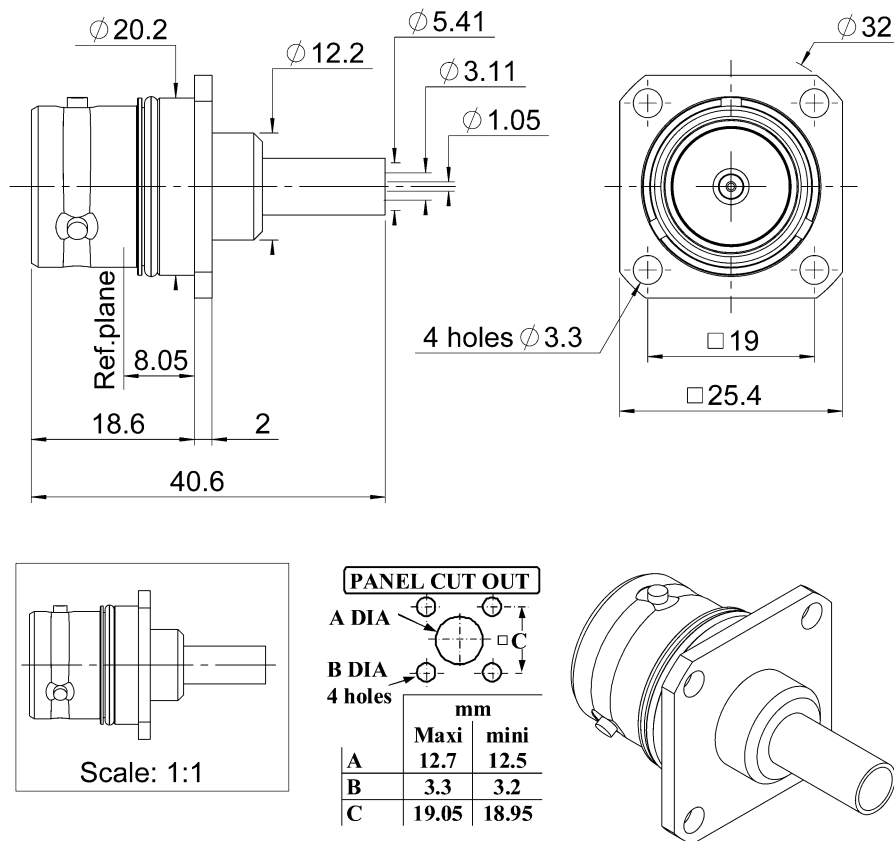

All dimensions are in mm.

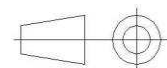

COMPONENTS	MATERIALS	PLATING (μm)
Body	BRASS	BBR
Center contact	BRONZE, BRASS	SILVER
Outer contact	-	-
Insulator	PTFE	
Gasket	SILICONE RUBBER	
Others parts	BRASS	BBR
-	-	-
-	-	-

PAGE **2/2**

ISSUE **1416B**

SERIES **QLI**

PART NUMBER **R184282007**

## PACKAGING

Standard	Unit	Other
<b>50</b>	<b>Contact us</b>	<b>Contact us</b>

## ELECTRICAL CHARACTERISTICS

Impedance	<b>50</b>	$\Omega$
Frequency	<b>0-6</b>	GHz
VSWR	<b>1.15* + 0.0000</b>	x F(GHz) Maxi
Insertion loss	<b>0.05</b>	$\sqrt{F}$ (GHz) dB Maxi
RF leakage	<b>NA</b>	- F(GHz)) dB Maxi
Voltage rating	<b>850</b>	Veff Maxi
Dielectric withstanding voltage	<b>1500</b>	Veff mini
Insulation resistance	<b>5000</b>	M $\Omega$ mini

## ENVIRONMENTAL

Operating temperature	<b>-55/+120</b>	°C
Hermetic seal	<b>NA</b>	Atm.cm3/s
Panel leakage	<b>NA</b>	

## SPECIFICATION

## MECHANICAL CHARACTERISTICS

Center contact retention		
Axial force – Mating End	<b>50</b>	N mini
Axial force – Opposite end	<b>30</b>	N mini
Torque	<b>NA</b>	N.cm mini

Recommended torque		
Mating	<b>NA</b>	N.cm
Panel nut	<b>NA</b>	N.cm
Clamp nut	<b>NA</b>	N.cm
A/F clamp nut	<b>0.0000</b>	mm

Mating life	<b>100</b>	Cycles mini
Weight	<b>37.0200</b>	g

## CABLE ASSEMBLY

Stripping	a	b	c	d	e	f
mm	<b>3.9</b>	<b>8</b>	<b>13.4</b>	<b>0</b>	<b>9.5</b>	<b>0</b>

Assembly instruction: **Crimp 01**

Recommended cable(s)

**RG 58**  
**KX 15**  
**RG 141**

Characteristics indicated on this data sheet are those that can be achieved with the highest performance cable. Intrinsic limitations of the cable may diminish the performance of the assembly

Cable retention

- pull off	<b>150</b>	N mini
- torque	<b>NA</b>	N.cm

## TOOLING

Part Number	Description	Hexagon
R282223000	CRIMPING TOOL	5.41
R282235011	CRIMPING DIES M22520/5-11	5.41
R282293000	CRIMPING TOOL M22520/5-01	

## OTHER CHARACTERISTICS

**IP 67 for interface**

**\*VSWR: Up to 3 GHz; 3-6 GHz, 1.2 Max**