

1. PARTS COMPLY TO AMP SOLDERABILITY SPECIFICATION 109-11-3.
- CONTACT IS PLATED OVERALL WITH 0.00127 [.000050] NICKEL, THEN 0.00076 [.000030] GOLD OVER CONTACT LENGTH INDICATED AND MATTE TIN LEAD ON SOLDER TAIL END.
- CIRCUIT IDENTIFICATION CHARACTERS ARE ADJACENT TO THE INDICATED CAVITIES, BUT LOCATION AND ORIENTATION MAY DIFFER FROM PRINT.
4. DIMENSIONS IN BRACKETS ARE IN INCHES.
- CONTACT IS PLATED OVERALL WITH 0.00127 [.000050] NICKEL, THEN 0.00076 [.000030] GOLD OVER CONTACT LENGTH INDICATED AND MATTE TIN ON SOLDER TAIL END.

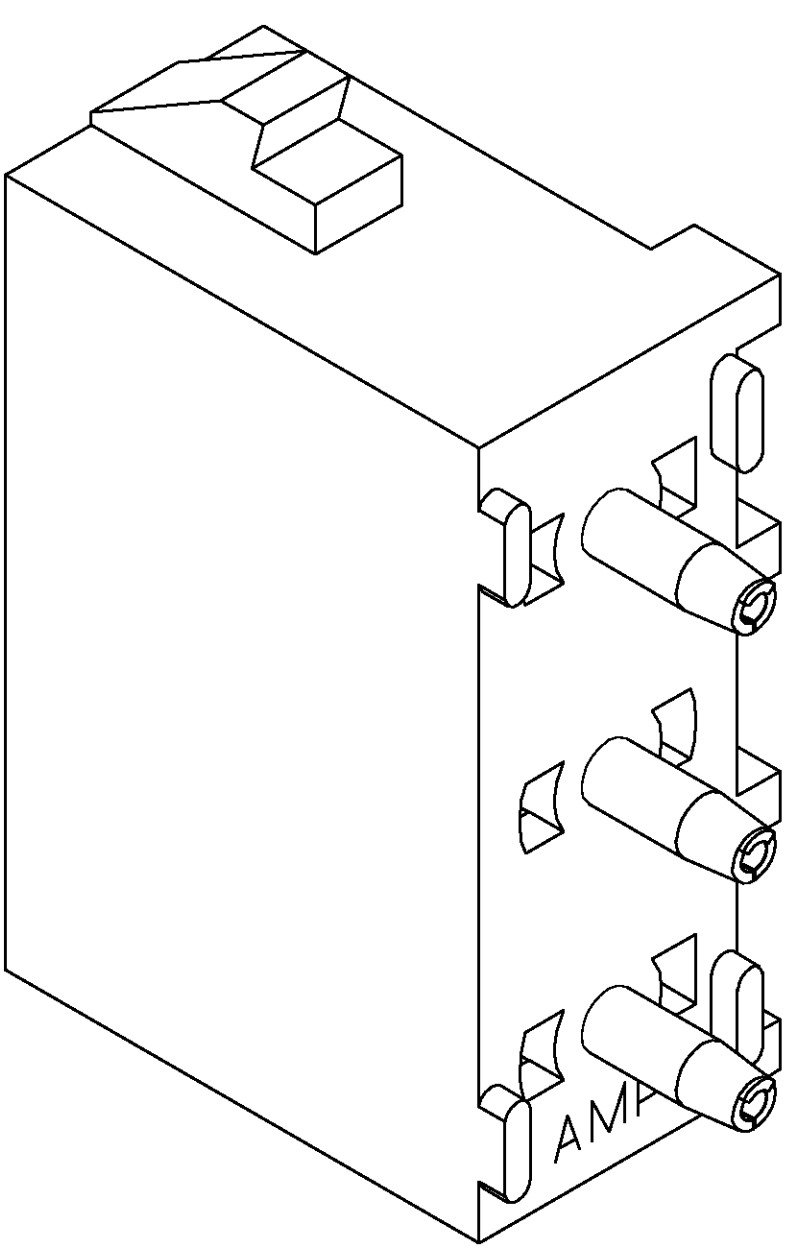

3-DIMENSIONAL MODEL  
NTS

PHOSPHOR BRONZE, GOLD	NYLON, UL94V-2,NATURAL	350429-4
PHOSPHOR BRONZE, GOLD	NYLON, UL94V-2,NATURAL	350429-2
PHOSPHOR BRONZE, PRE-TIN	NYLON, UL94V-2,NATURAL	350429-1
PIN CONTACT MATERIAL AND FINISH	HOUSING MATERIAL	PART NUMBER

THIS DRAWING IS A CONTROLLED DOCUMENT.	DWG B. LEWIS CHK R. SWING APVD M. TRULL PRODUCT SPEC	8-19-98 8-19-98 8-19-98	Tyco Electronics Corporation Greensboro, NC 27409
DIMENSIONS: mm [INCHES]	TOLERANCES UNLESS OTHERWISE SPECIFIED:	NAME	
0 PLC ± -	0 PLC ± -	APPLICATION SPEC	SIZE
1 PLC ± -	1 PLC ± -	WEIGHT	CAGE CODE
2 PLC ± 0.13 [.005]	2 PLC ± 0.13 [.005]	CUSTOMER DRAWING	DRAWING NO
3 PLC ± -	3 PLC ± -	SCALE	SHEET
4 PLC ± -	4 PLC ± -	5:1	1 OF 1
ANGLES	± - 0° 30'		REV
FINISH			Y

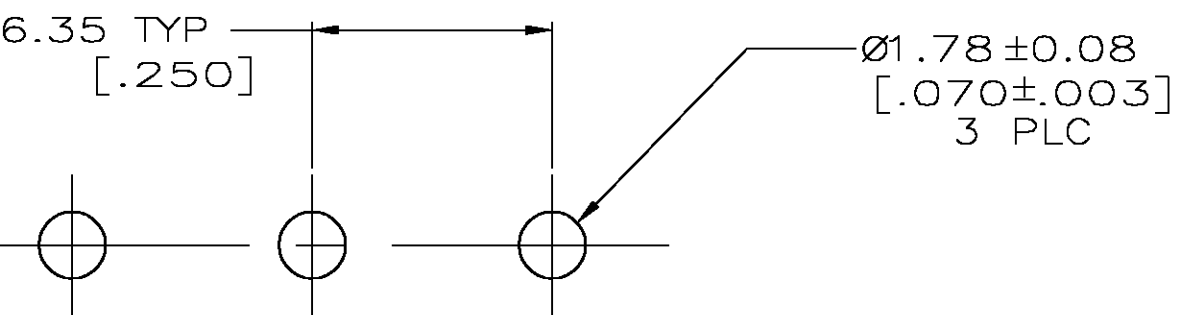
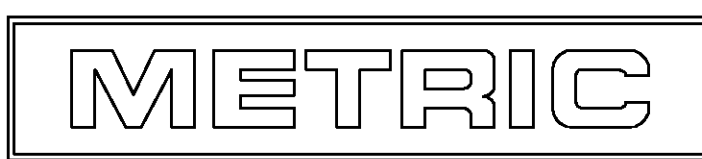

RECOMMENDED MOUNTING HOLE PATTERN  
FOR 1.57 [.062] THICK P.C. BOARD