

D

C

B

A

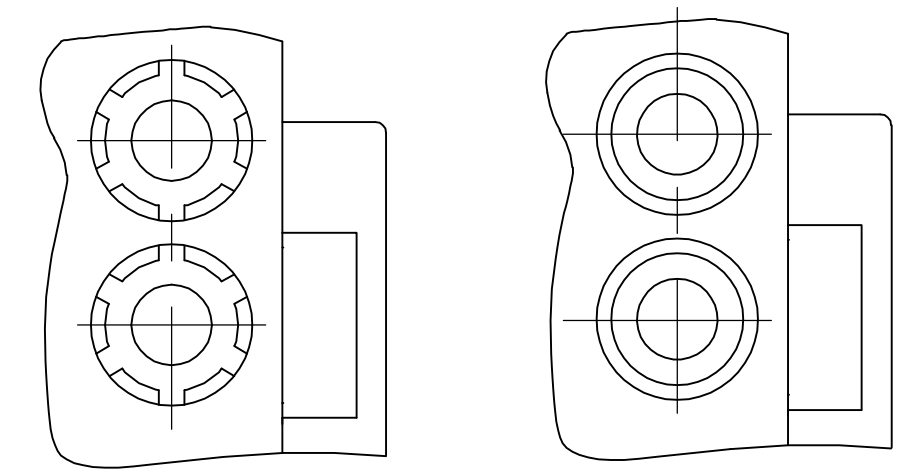
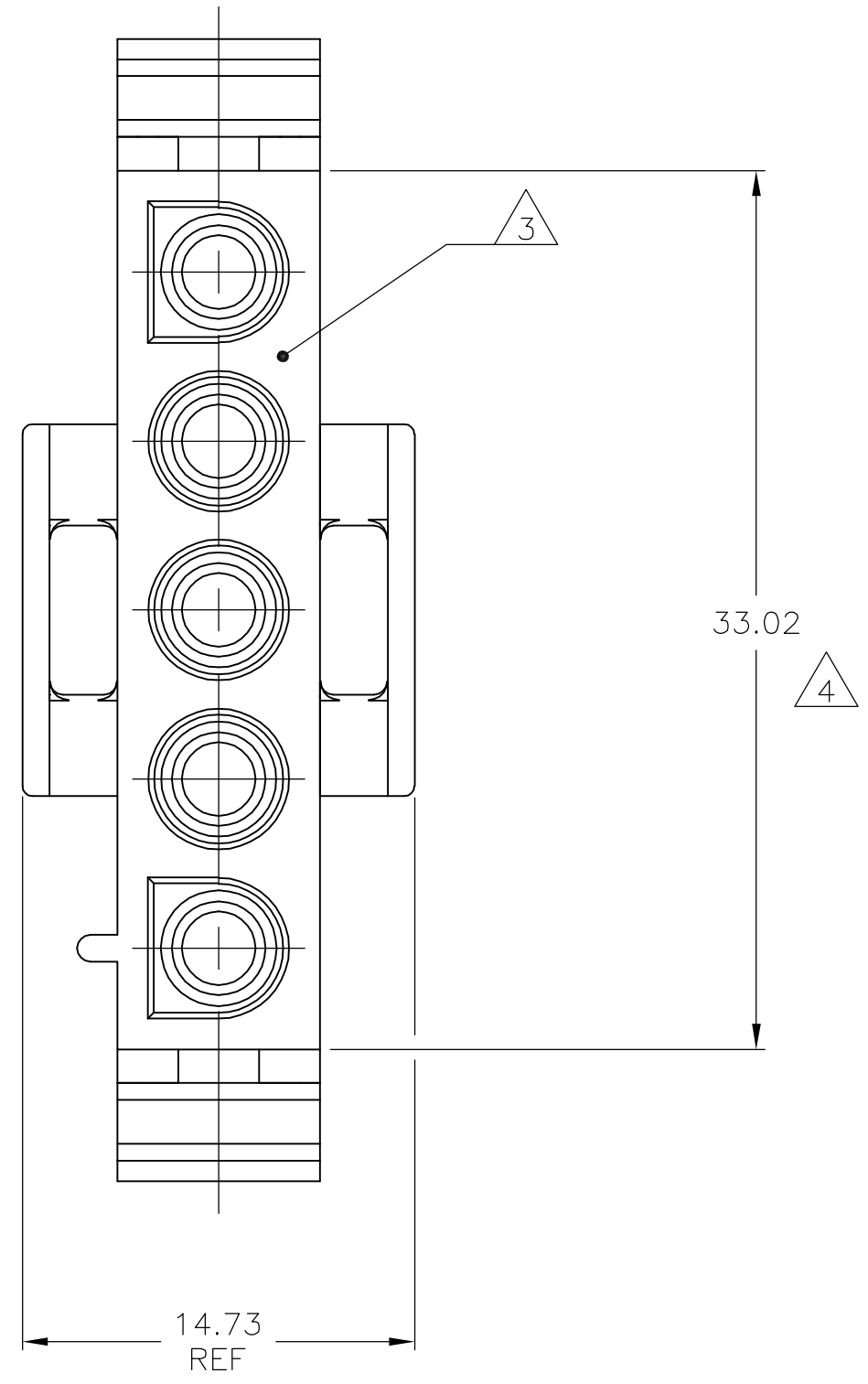
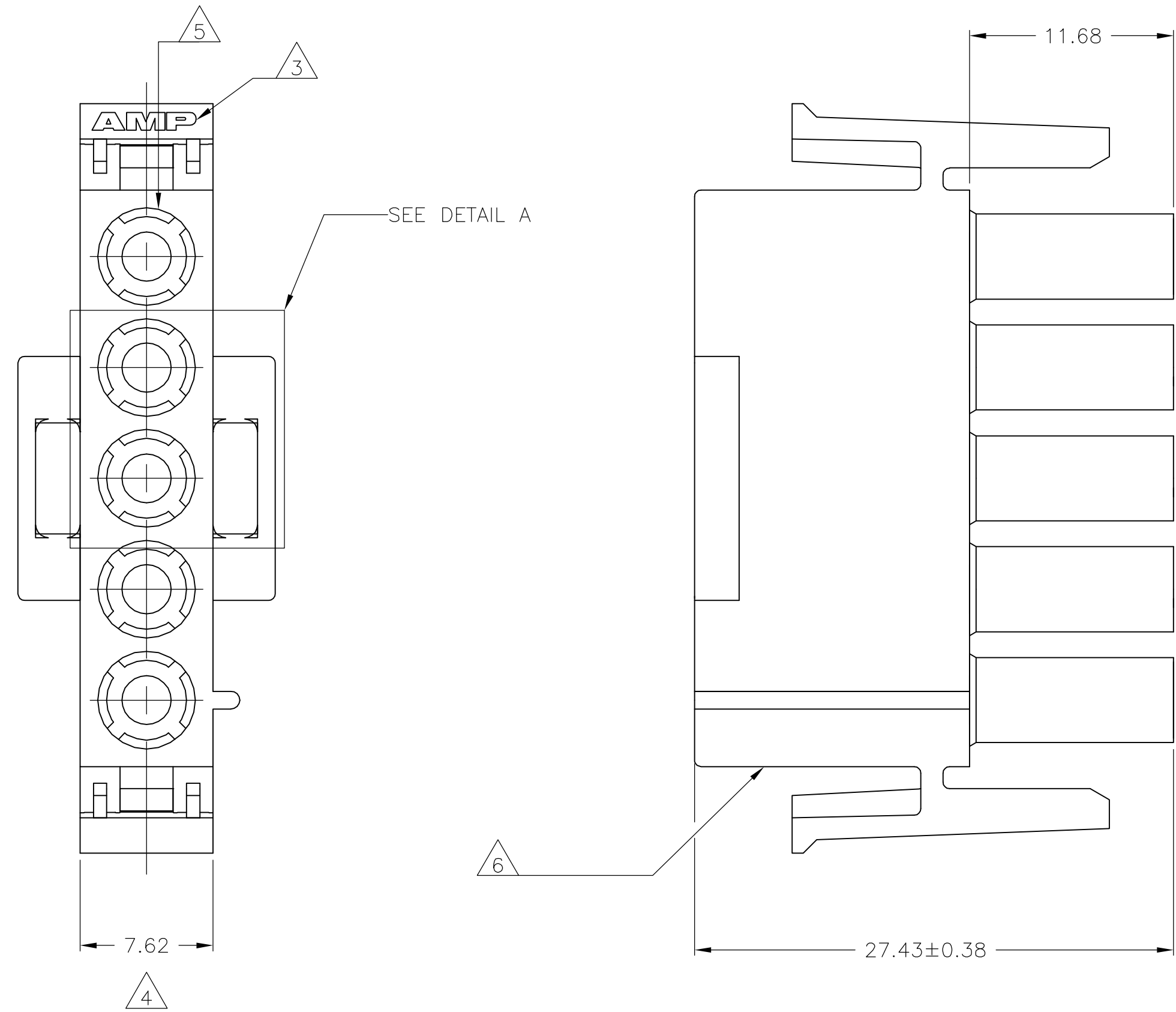

DETAIL A  
OPTIONAL CONSTRUCTIONS

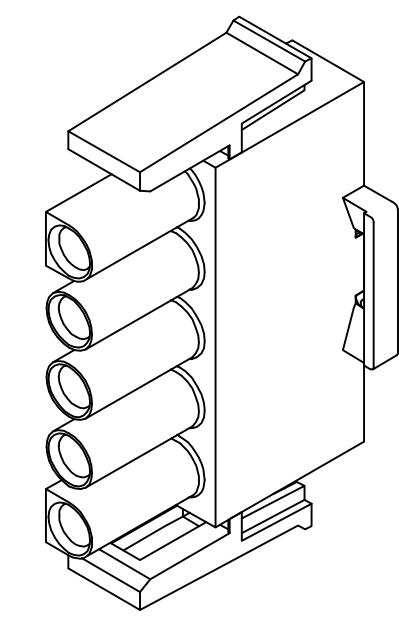

3-DIMENSIONAL MODEL  
NTS

33.02	1.300
27.43	1.080
14.73	.580
11.68	.460
7.62	.300
0.38	.015
0.13	.005
MM	IN
CONVERSION TABLE	

AMP 4805 REV 31MAR2000

- MATES WITH APPROPRIATE UNIVERSA MATE-N-LOK™ CAP OR HEADER.
- SMALL NICKS ARE PERMITTED ON THE CIRCUIT TOWERS WHICH COULD INCREASE THE INITIAL HOUSING MATING FORCE BY UP TO 4.4 NEWTONS [1.0 LBS]. NO INDIVIDUAL NICKED TOWER SHALL INCREASE THIS FORCE BY OVER 2.2 NEWTONS [.5 LBS].
- OPTIONAL: AMP LOGO MAY BE LOCATED ON THIS SURFACE.
- DIMENSION INDICATED IS AS MOLDED. ADDITIONAL GROWTH DUE TO SUBSEQUENT MOISTURE ABSORPTION MAY OCCUR.
- FOUR RIBS EQUALLY SPACED, NO SPECIFIC ORIENTATION. NO RIBS OR SIX RIBS EQUALLY SPACED, NO SPECIFIC ORIENTATION, OPTIONAL.
- UNDERWRITERS RECOGNIZED COMPONENT LOGO AND CSA CERTIFICATION LOGO TO BE LOCATED ONCE EACH ON SIDE OF HOUSING.

BLACK	480763-9
GRAY	480763-8
BLUE	480763-6
GREEN	480763-5
YELLOW	480763-4
ORANGE	480763-3
RED	480763-2
BROWN	480763-1
NATURAL	1-480763-0
COLOR	PART NO.

METRIC

THIS DRAWING IS A CONTROLLED DOCUMENT.

DWN  
R. VESTAL  
24FEB95

CHK  
R. SWING  
24FEB95

APVD  
D. SELF  
24FEB95

tyco  
Electronics

Tyco Electronics Corporation  
Harrisburg, PA 17105-3608

DIMENSIONS:  
mm

TOLERANCES UNLESS OTHERWISE SPECIFIED:  
0 PLC ± -  
1 PLC ± -  
2 PLC ± 0.13  
3 PLC ± -  
4 PLC ± -  
ANGLES ± 0.30°  
FINISH -

PLUG,  
5 CIRCUIT,  
UNIVERSAL MATE-N-LOK™

MATERIAL  
NYLON, UL 94V-2

WEIGHT  
-

CUSTOMER DRAWING

SIZE  
A1

CAGE CODE  
00779

DRAWING NO  
480763

RESTRICTED TO  
-

SCALE  
4:1

SHEET  
1 OF 1

REV  
AC