



EZ-141-CU-TP



Non-Magnetic

Copper jacketed semi-rigid cables manufactured by EZ Form offer 100% shielding and are easily formed into custom shapes using standard tooling. A wide variety of standard connectors are available for these cables.

To avoid oxidation, we recommend keeping this product in its original packaging and storing it in a dry temperature controlled environment until consumed.

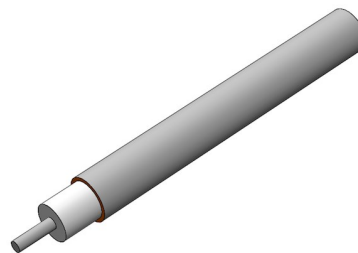
[ADD TO INQUIRY](#)[INQUIRY \(0\)](#)Category: **Semi Rigid Cable**

SPECIFICATIONS

DIMENSIONS

UNITS

EZ-141-CU-TP
REV A

Outer Conductor Diameter	In	.141*
	mm	3.58*
Center Conductor Diameter	In	0.0362
	mm	0.92
Dielectric Diameter	In	0.1175
	mm	2.98

MATERIALS

Outer Conductor		Copper
Outer Conductor Plating		Tin
Dielectric		PTFE
Center Conductor		SPC
RoHS Compliant		YES

MECHANICAL CHARACTERISTICS

Temp Range °C	°C	-55 to +125°C
Inside Bend Radius (Minimum)	In	0.25
	mm	6.35
Weight	lbs / 100ft	3.5
	kg / 100m	5.21

ELECTRICAL CHARACTERISTICS**

Nominal Impedance	Ohms	50.0 ±1.0
Velocity of Propagation	-	69.5%
Shielding Effectiveness	db	>165
Voltage Withstanding	VRMS @ 60 Hz	5000
Continuous Working Voltage	VRMS MAX	1900
Maximum Operating Frequency	GHz	34
Attenuation (db / 100 Ft Typical)	0.5 GHz	7.6
	1.0 GHz	11.1
	5.0 GHz	28.1
	10.0 GHz	43.4
	18.0 GHz	63.6
	26.5 GHz	82.8
	40.0 GHz	N/A
	50.0 GHz	N/A
	65.0 GHz	N/A
Power (Watts Cw @ 20 °C, Maximum)	0.5 GHz	600
	1.0 GHz	450
	5.0 GHz	180
	10.0 GHz	120
	18.0 GHz	73
	26.5 GHz	70
	40.0 GHz	N/A
	50.0 GHz	N/A
	65.0 GHz	N/A
	90.0 GHz	N/A

* Allow additional .001" for plating.

** Applicable at ambient temperature. Contact factory for performance over temperature range.

Tel: (203) 785-8215 **Fax:** (203) 785-0466 | 285 Welton Street Hamden, CT 06517

Website: www.ezform.com © Copyright 2018 EZ Form Cable Corporation