

ATTENUATORS

SMA, up to 4 GHz, 150 Watts

SPECIFICATIONS:

Models: XB 150W-XX, XB 150W-XXF, XB 150W-XXM

RoHS
Compliant

AEROFLEX
A passion for performance.

Electrical:

Frequency Range _____ DC - 4.0 GHz
Standard Freq. Values _____ 2.5 & 4 GHz
Standard dB Values _____ 3, 6, 10, 20, 30 & 40 dB
Attenuation Accuracy DC - 1.5 GHz 1.5 - 2.5 GHz 2.5 - 4 GHz
3 & 6 dB _____ ± 0.50 dB _____ ± 1.00 dB _____ ± 1.50 dB
10 & 20 dB _____ ± 0.50 dB _____ $\pm .75$ dB _____ ± 1.00 dB
30 & 40 dB _____ ± 0.75 dB _____ ± 1.00 dB _____ ± 1.50 dB
Input VSWR (Max.) _____ 1.15:1 _____ 1.25:1 _____ 1.35:1
Input Power _____ 150 Watts Avg. @ +25°C
Derated Linearly to 30 Watts @ +125°C
Peak Power _____ 2 kW Max.
(5uSec Pulse, .05% Duty Cycle)
Impedance _____ 50 Ohms
Operating Temp Range _____ -54°C to +125°C

Mechanical:

SMA Connectors _____ Passivated Stainless Steel
Mates with MIL-STD-348
Conductors _____ Gold Plated Beryllium Copper
Housing _____ Anodized Aluminum

Custom Mtg. hole Config.
may be Added to this
Surface

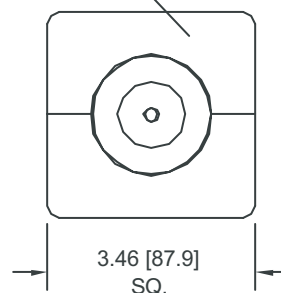

END VIEW
TYPICAL

Units must be Mounted in such a way as to
Allow for Free Air Flow Around fins to Assure
Performance

Note: Units are Unidirectional, Therefore Input Connector MUST be Specified & will be Indicated on Unit

Model Number: **XB150W-XX**

Male/Female Connectors
Length: 5.66 \pm .05 [143.8 \pm 1.3]
Pictured

Model Number: **XB150W-XXF**

Female/Female Connectors
Length: 5.52 \pm .05 [140.2 \pm 1.3]

Model Number: **XB150W-XXM**

Male/Male Connectors
Length: 5.79 \pm .05 [147.1 \pm 1.3]

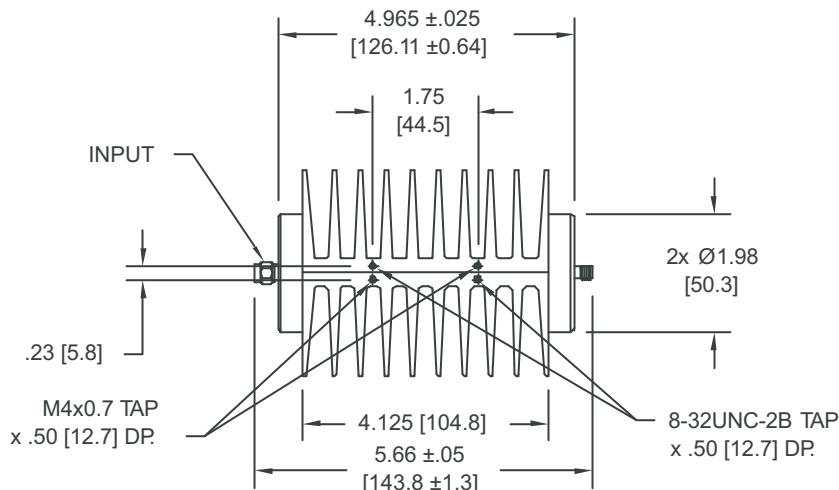

HOW TO ORDER:

Model Number: **XB150W-XXY**

Freq. Range
2 = DC - 2.5 GHz
4 = DC - 4 GHz

Connector Configuration
= Male/Female
F = Fem/Fem
M = Male/Male
dB Value

Ordering Examples:

Model Number: **4B150W-10**
DC - 4 GHz, 10 dB; SMA - Male/Fem

Model Number: **2B150W-3F**
DC - 2.5 GHz, 3 dB; SMA - Fem/Fem

Note: Dimensions in Brackets are Expressed in Millimeters and are for Reference Only.
Design, specifications are subject to change without notice. Contact factory for technical
specifications before purchasing and/or use.

XB 150W-ATT: REV F

AEROFLEX
INMET

Aeroflex / Inmet, Inc. • 300 Dino Drive, Ann Arbor, MI 48103 • U.S.A.
888-244-6638 or 734-426-5553 • FAX: 734-426-5557
www.aeroflex.com/inmet • inmet-sales@eroflex.com